

DATE CODE:

YYWW

YEAR
EX.14=2014
WEEK CODE

SPECIFICATION

MATERIAL
 Insulator: PA66, rated UL94V-0
 Shell: SUS 304-1/2H
 Slider: SUS 304-1/2H
 Coil Spring: SWP-B
 Cam Rod: SUS 304-1/2H
 Nuts: C3604
 Part no.

S 752J H 64 B D T F1 1 A 3
 1 2 3 4 5 6 7 8 9 10 11

- 1.S=SEMI FINISHED PRODUCT
- 2.SERIES NO.
752J=CFast
- 3.GREEN OPTION:
H=RoHS+HF (Matte)
- 4.CONTACT NUMBER:
64=64 Pins

- 5.CONTACT TYPE:
B=FEMALE (LCP)
- 6.CONTACT AREA PLATING:
D=30u" Gold
- 7.SOLDER TAILS AREA PLATING:
T=50u"~150u" TIN (Lead Free)
- 8.APPLY TYPE:
F1=Type
- 9.1=Cage
- 10.PACKING STYLE:
A=TRAY
- 11.INSULATOR COLOR:
3=Black

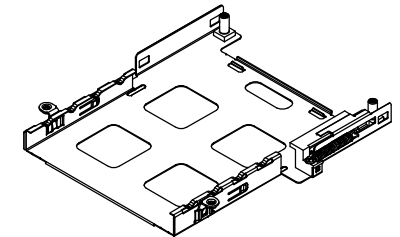
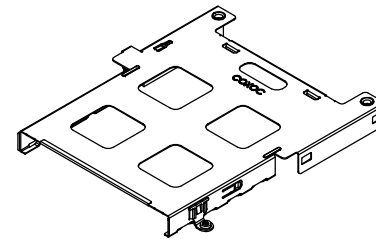

UNLESS OTHERWISE SPECIFIED TOLERANCE
 ANG. ±5°
 0. ±0.50
 .0 ±0.30
 .00 ±0.20



CHANT SINCERE CO.,LTD
 TEL:886-02-86471251 FAX:886-02-86472962

SCALE:	AS SHOWN	UNIT:	mm
DRAWN	JERRY	DATE	03/01/18
CHECKED			/ /
APPROVED			/ /

DRAWN NAME:	CFast Cage
PRODUCT NO.	S752JH64BDTF11A3
FILE NAME:	S752JH64BDTF11A3

REV.	DESCRIPTION	DATE	SIZE	REV.	FILE NAME
1			A4	X1	S752JH64BDTF11A3

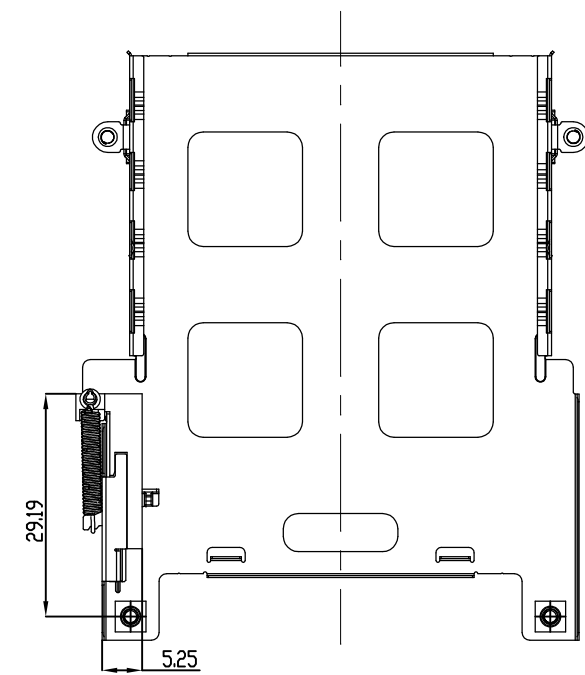
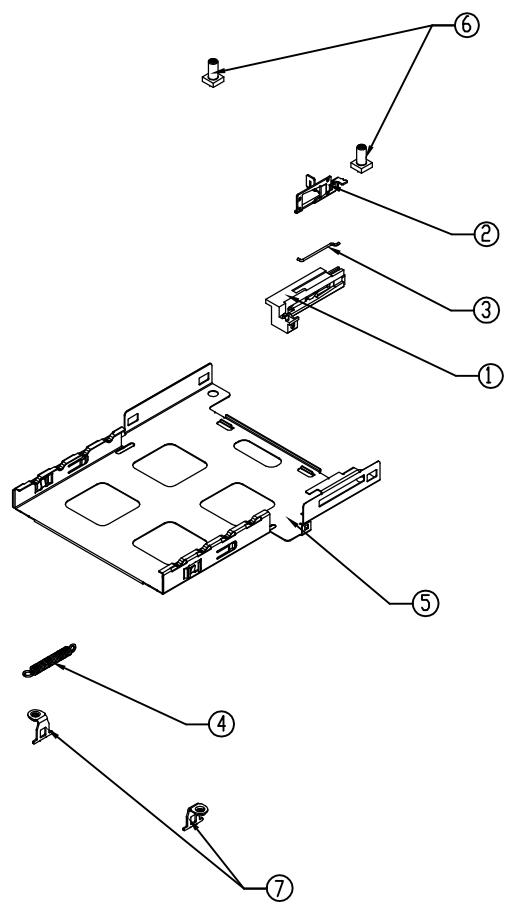

Bottom View

Item	Part Name	Part No	Material	Q'ty
1	Guide Rail Housing	M1752JC64FF1303A	PA66	1PCS
2	Slider	M4752JE270F1001A	SUS 304-1/2H, T=0.40mm	1PCS
3	Cam Rod	M4752JE240F1003A	SUS 304-1/2H	1PCS
4	Coil Spring	M4752JESPNF1002A	SWP-B	1PCS
5	Host Top Shell	M3752JE00F80F11A	SUS 304-1/2H, T=0.25mm	1PCS
6	Nuts	M4752JE62NF1004A	C3604	2PCS
7	Bracket	M4752JE280F1705A	SUS 304-1/2H, T=0.40mm	2PCS

UNLESS OTHERWISE SPECIFIED TOLERANCE
 ANG. ±5°
 0. ±0.50
 .0 ±0.30
 .00 ±0.20



CHANT SINCERE CO.,LTD
 TEL:886-02-86471251 FAX:886-02-86472962

SCALE: AS SHOWN UNIT: mm
 DRAWN: JERRY 03/01/18
 CHECKED: / /
 APPROVED: / /

DRAWN NAME: CFast Cage 2/2
 PRODUCT NO. S752JH64BDTF11A3
 FILE NAME: S752JH64BDTF11A3

REV.	DESCRIPTION	DATE
1		

SIZE A4 REV. X1