



CHANT SINCERE CO., LTD.



# PC & Peripheral

- ▮ D-Sub
- ▮ High Density D-Sub



## Table Of Contents

About Chant Sincere .....	03
Quality Systems .....	05
Competencies & Technology .....	07
D-Sub .....	09
High Density D-Sub .....	15







## About Chant Sincere

**Chant Sincere Co., Ltd.** was set up in 1985, with the management concept of "Integrity, Innovative, Quality, Sustainability" to design and manufacture connector and cable. Keep developing new innovative products and integrating vertically from R&D, tooling, assembly and quality control to meet the demands (quality-cost/delivery) from customers. Chant Sincere Co., Ltd. has been constructing several of product families to provide a total solution to customers.

The connector and cable products are widely used in many different applications, such as Computing, Industrial & Automation, Telecommunication, Automotive, Waterproof, Consumer and Medical Industry.

**Chant Sincere** won the "National Bedrock Award" & "Small Giant Award" from Taiwan Connector maker competition and got many "Best Supplier Awards" from Global customers. We are focusing on improving our design and manufacture technology, and we have been applying for a lot of international patents for our products including I/O connector, Board to Board Connector, Waterproof Connector, Industrial Connector, Automotive Connector, Memory Card Connector and Adaptor, High Speed connector/cable (USB3.1), Audio & Video connector and cable (HDMI, DisplayPort)...etc.

Chant Sincere Co., Ltd. has been growing up as a global professional manufacturer for connector and cable.

### The Core Competence of Chant Sincere Co.,Ltd. including.

- Over 40 Years Manufacture Experience
- National Awards Rising Sun Awards/Best Supplier Awards
- Vertical Integration (Design, Tooling, Manufacturing, Test)
- Automation Capability
- Precise Tooling Center
- Wide Range of Product Line
- ODM/OEM Capability
- Customized Capability
- Quality System (ISO, IATF)
- Systematic Testing Process



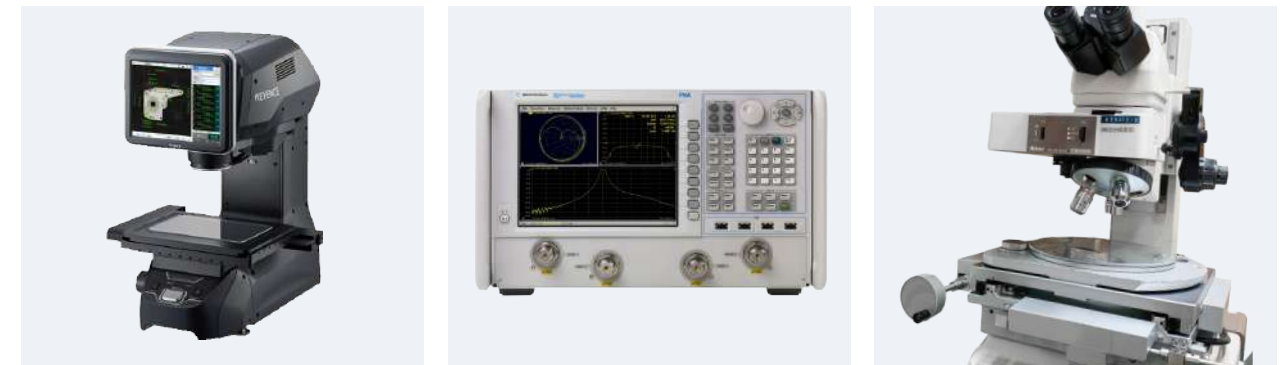
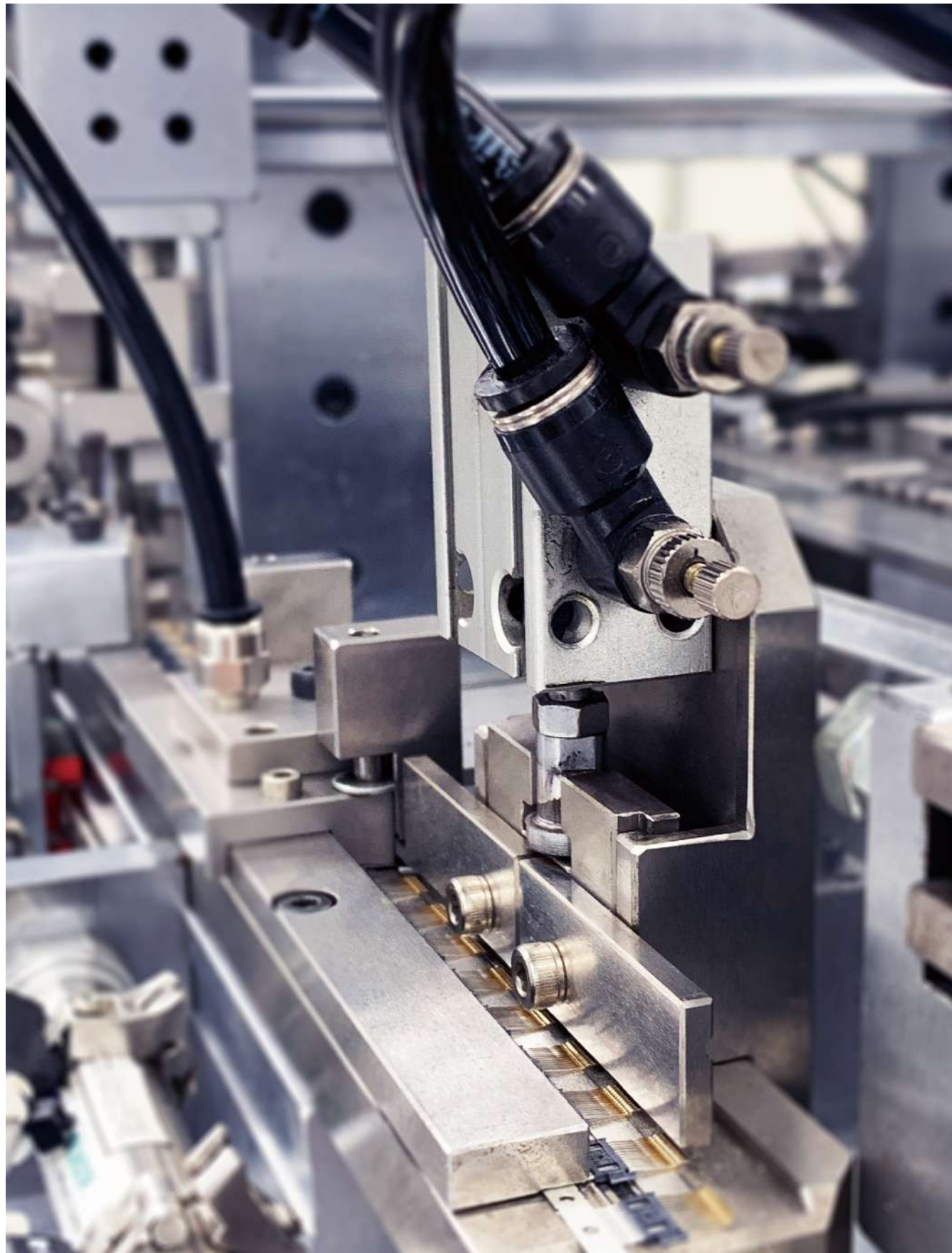

## Quality Systems

Chant Sincere (hereinafter referred to as C.S.) Quality Assurance department meets our customers' quality requirements by practicing continual improvement in our quality assurance processes and increasing customers' satisfaction in the quality of our products.

The effectiveness of QA operation is certified by well-known organizations such as ISO9001 Quality Assurance Management System, ISO 14001 Environmental Management System, ISO/IATF 16949 for Automobile Industry Quality Management System, and ISO13485 Medical Devices Quality Management System. C.S. integrated supply chain and devoted staff has enabled us to build a solid foundation and core capability to better serve our customers. It is principal to always meet and exceed customer expectation by providing superior products and services. Our ultimate goal is to create value for our customers by building collaborative and mutually beneficial relationships.



ISO 14064-1 / ISO 9001 / ISO 14001 / IATF 16949 / ISO 13485





## Competencies & Technology

The R&D Center at Chant Sincere leads the industry in research, design, and manufacturing of numerous key parts. This center has successfully developed for both wired and wireless solutions for computer peripherals, communication systems, and automobiles/industrial/medical equipment. Our solid R&D team formed a strong foundation in advance manufacturing technology and superior quality control that also enabled high value adding service for customers.

USB type C connector is an example of the fruits of our research. This miniature and unidirectional interface provides many useful functions such as lighting data transfer rate up to 10 Gbps, DP ALT Mode high-definition video signal support, and brilliant 100W charging capability. Chant Sincere advanced the research further into higher specs such as USB 3.2 and USB 4.0 and offers customized solution for several of industrial applications. We delivered comprehensive solutions in bridging the diverse need for new interface and solve on-going product design issues for customers.

QSFP-DD is an ultra-fast interface that transmits data at 400Gbps speed.

At this speed, stringent requirement for signal integrity and operating temperature is inevitable which imposed huge challenges for the industry. At Chant Sincere, we implemented comprehensive computational software, state of art measuring equipment and eminent R&D capability to aid the solution delivering process. The analysis process includes simulation under CST MSW (Time Domain Simulation), ANSYS HFSS (Frequency Domain Simulation) for signal integrity as well as real-time measurement using test boards and PNA (up to 43.5GHz) to deliver quality reports for signal integrity (S-parameter, Gain compression, conversion gain/loss, noise level). We further performed simulation of its operating temperature using Icepak (Heat transfer and fluid flow simulator). This enabled the performance optimization for heat dissipation solution. With the above R&D skills we successfully delivered the desired professional service within the shortest time frame for our customers.



# D-Sub

## D-Sub Application

The D-Subminiature or D-Sub is a common type of electrical connector. They are named for their characteristic D-shaped metal shield. When they were introduced, D-Subs were among the smallest connectors used on computer systems. A D-Sub contains two or more parallel rows of pins or sockets usually surrounded by a D-shaped metal shield that provides mechanical support, ensures correct orientation, and may screen against electromagnetic interference.

## Application

- Desktop
- Notebook
- Embedded System
- Projector
- VGA Card/ Mother Board
- Medical

## Product Characteristics

- 5 sizes with connector mating layouts ranging from 9 positions to 50 positions.
- Standard D-Sub has signal contacts with current rating of 5A
- D-shaped metal shield provides seamless connection and reduce electromagnetic interference.
- D-Sub connectors, including solder cup, PCB, press-fit and wire wrap connections.

# D-Sub PCB Right Angle

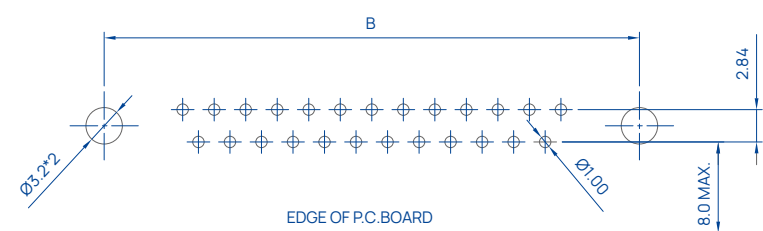
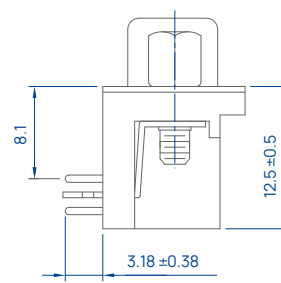
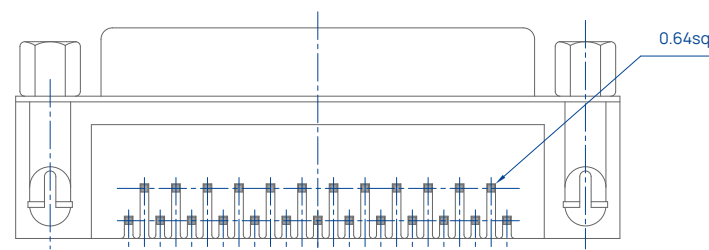
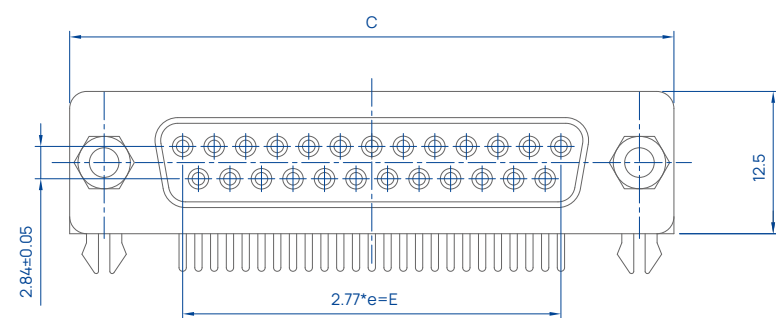
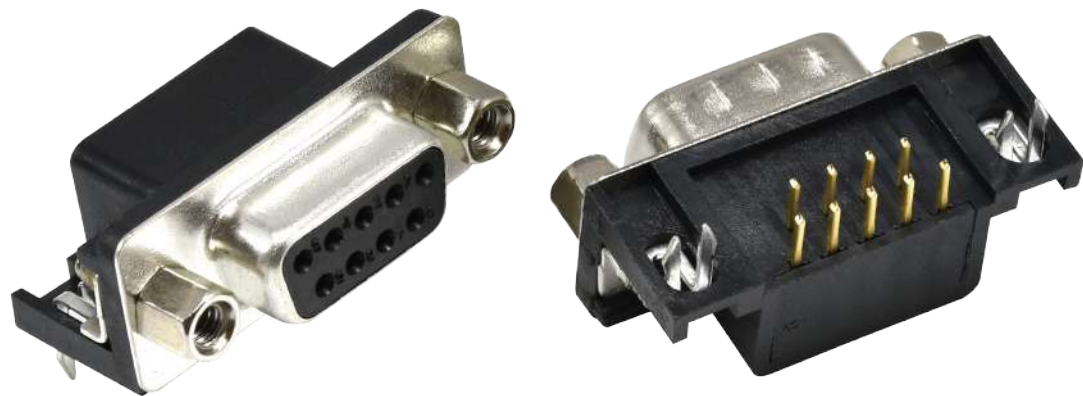

RECOMMENDED P.C.B LAYOUT (TOP VIEW)  
TOLERANCES: ±0.05mm

POSITION	A	B	C	d	D	e	E
09F	16.30	25.00	30.8	03	08.31	04	11.08
15F	24.60	33.30	39.2	06	16.62	07	19.39
23F	35.30	44.30	50.3	10	27.70	11	30.47
25F	38.30	47.10	53.1	11	30.47	12	33.24
37F	54.80	63.50	69.4	17	47.09	18	49.86

PARTS DIMENSION TABLE			
parts no.	DIM. a	DIM. b	inner thread
C	4.8	11.8	4#40
E	5.8	12.0	4#40
G	4.8	11.8	M3
H	6.0	13.2	M2.6
I	5.8	11.8	M3
X	4.8	11.8	M2.6
Z	5.8	12.0	M2.6
7	6.0	12.0	4#40
9	6.1	12.0	4#40

## Specification

Part No.	50224XXXXXX / 50225XXXXXX
Contacts	9, 15, 25, 37
Material	
Insulator	Thermal Plastic UL94V-0
Contacts	Copper Alloy
Shell	Stainless Steel
Shell	Steel
ivet,Boardlock	Copper Alloy
Contact Plating	
Under Plate	50u" Nickel
Contact Area	1u" ~ 30u" Selective Gold
Solder Tails Area	100u" Tin/Lead (Brighten Tin) or 100u" Tin/Lead Free (Brighten Tin/Matte Tin)
Electrical	
Operation Voltage	250 VAC Max.
Current Rating	3 Amps Max.
Contact Resistance	15 Mohms Max.
Insulation Resistance	3000 Mohms Min @500 VDC
Dielectric Withstanding Voltage	1000 VAC / Minute
Operating Temperature	-55°C to +105°C



D-Sub Series

Product List	Description	Part No.
	Male / Female , 9~37Pin, Cable Assembly Solder	50205 / 50206
	Male / Female , 9~37Pin, PCB Mount 180°	50203 / 50204
	Male / Female , 9~37Pin, PCB Mount 180°	50218 / 50219
	Male / Female , 9~37Pin, PCB Mount 180°	50222 / 50223
	Male / Female , 9~37Pin, PCB Mount 90°	50224 / 50225
	Male / Female , 9~37Pin, PCB Mount 90°	50233 / 50234
	Male / Female , 9~37Pin, PCB Mount 90°	50235 / 50236

D-Sub Series

Product List	Description	Part No.
	Male / Female , 9~37Pin, PCB Mount 90°	50237 / 50238
	Male / Female , 9~37Pin, PCB Mount 90°	50239 / 50240
	Male / Female , 9~37Pin, Cable Assembly Crimp	50241 / 50242
	Male / Female Cable Assembly Crimp	50243 / 50244
	Male / Female , 9~37Pin, Cable Assembly I.D.C	50226 / 50227
	Male / Female , 9~37Pin, PCB Mount 90°	50211 ~ 50215
	Male, 9Pin, PCB Mount 180°	50245 / 50246





# High Density D-Sub

## High Density D-Sub Application

High Density D-Sub connectors are a refined version of the standard D-Subminiature (D-Sub) connectors, offering increased contact density within the same shell size. These connectors are widely used in various data, signal, and power transmission applications where space-saving and reliable connections are essential.

## Application

- Telecommunications Equipment
- Industrial Automation
- Medical
- Desktop
- Notebook
- Test and Measurement Equipment

## Product Characteristics

- High Contact Density  
Offers up to 78 contacts in the same form factor as standard D-Sub connectors.
- Compact Design  
Saves PCB space and allows more I/O connections in a limited area.
- Secure Mechanical Connection  
Locking hardware ensures a reliable and vibration-resistant connection.
- Versatile Mounting Options  
Available in through-hole, right-angle, and SMT (Surface Mount Technology) configurations.

# High Density D-Sub PCB Right Angle



The image displays two views of a High Density D-Sub PCB Right Angle connector. The left view shows the front of the connector, which features a black plastic housing and a silver-colored metal shell. The shell has a D-sub interface with 25 pins (12 on the top and 13 on the bottom) and two mounting tabs. The right view shows the back of the connector, revealing the internal gold-plated pins and the right-angle mounting bracket.

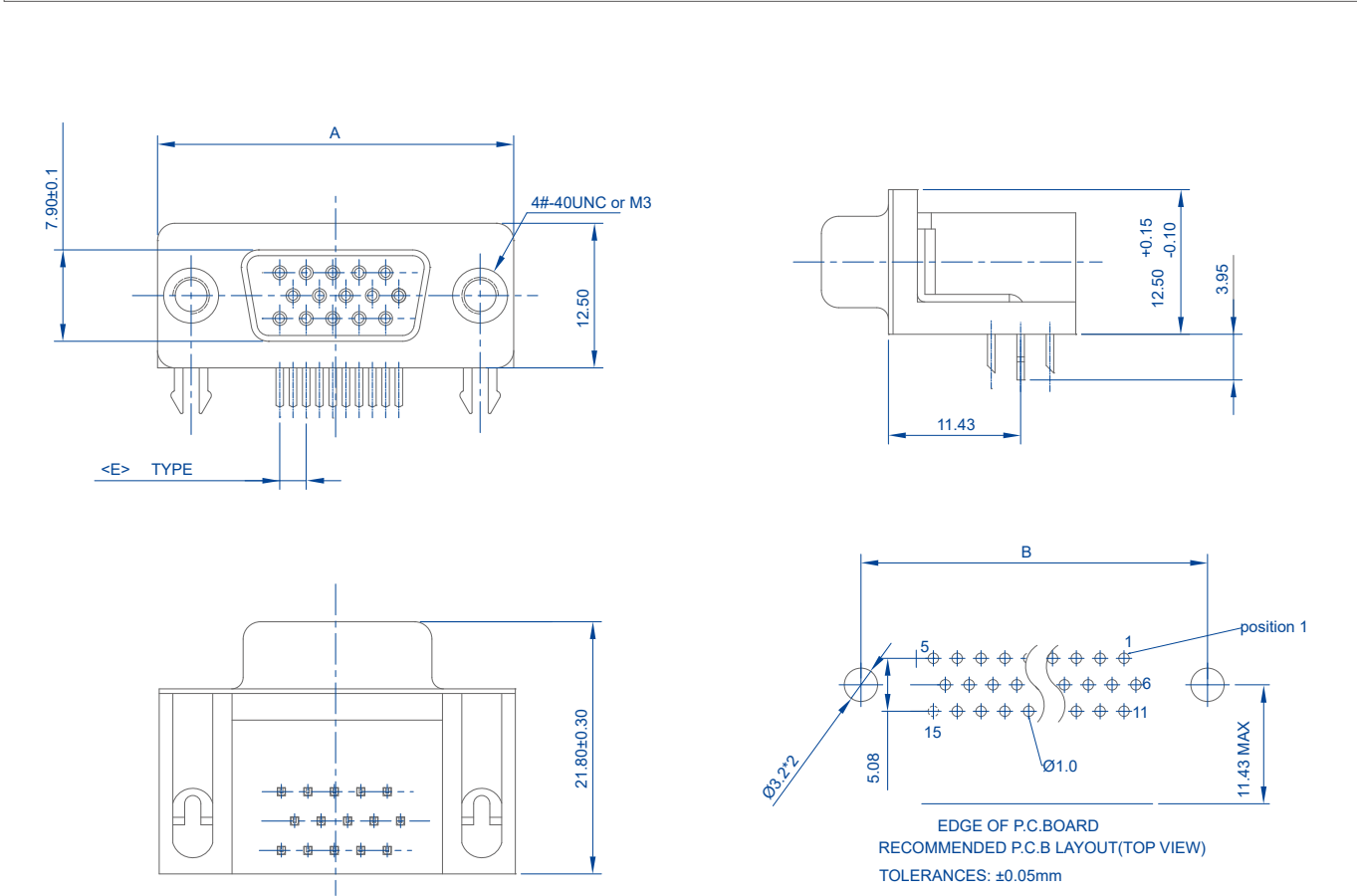

POS.	A	B	C	E
15	30.80	24.99	16.30	2.29
26	39.2	33.32	23.20	2.29
44	53.10	47.04	38.30	2.29
62	70.00	63.50	54.8	2.41

Specification	
Part No.	50105XXXXXX / 50106XXXXXX
Contacts	15, 26, 44, 62
Material	
Insulator	PBT+30% Glass Fiber(UL94V-0).
Contacts	Brass
Under Plate	40u" Min. Nickel
Contact Area	1u" ~ 30u" Selective Gold
Solder Tails Area	80u" Min. Tin(Lead Free) or Gold Flash
Shell	Steel, N=40u" Nickel Or T=40u" Tin Over 40u" Cu X=1st Cu:40u"~200u". 2nd 40~200u" Nickel Plated. 3rd 80~300u" Tin Plated
Electrical	
Current Rating	5 Amps
Contact Resistance	15 Mohms Max.
Insulation Resistance	1000 Mohms Min. at 500 VDC
Dielectric Strength	1000 VAC / Minute
Operating Temperature	-55°C t o +105°C

Part No.	50105XXXXXX / 50106XXXXXX
Contacts	15, 26, 44, 62
Material	
Insulator	PBT+30% Glass Fiber(UL94V-0).
Contacts	Brass
Under Plate	40u" Min. Nickel
Contact Area	1u" ~ 30u" Selective Gold
Solder Tails Area	80u" Min. Tin(Lead Free) or Gold Flash
Shell	Steel, N=40u" Nickel Or T=40u" Tin Over 40u" Cu X=1st Cu:40u"~200u". 2nd 40~200u" Nickel Plated. 3rd 80~300u" Tin Plated
Electrical	
Current Rating	5 Amps
Contact Resistance	15 Mohms Max.
Insulation Resistance	1000 Mohms Min. at 500 VDC
Dielectric Strength	1000 VAC / Minute
Operating Temperature	-55°C t o +105°C



# High Density D-Sub

Product List	Description	Part No.
	Male / Female , 15~62Pin, Cable Assembly Solder	50103 / 50104
	Male / Female , 15~62Pin, PCB Mount 180°	50101 / 50102
	Male / Female , 15~62Pin, PCB Mount 90°	50105 / 50106
	Male, 15Pin, Cable Assembly	50107 / 50108
	Male / Female , Cable Assembly Crimp	50107 / 50108





 **CHANT SINCERE CO., LTD.**

7F-2, No 188, Sec. 3, Datong Road  
Xizhi, New Taipei City 22103, Taiwan

 [www.coxoc.com.tw](http://www.coxoc.com.tw)

 +886-2-8647-1251

 [service@coxoc.com.tw](mailto:service@coxoc.com.tw)



[www.coxoc.com.tw/en](http://www.coxoc.com.tw/en)