

SPECIFICATION
 MATERIAL
 Insulator: Thermoplastic
 Contacts: Copper Alloy
 Shell: Steel
 O-ring: Silicone
 Sealant: Epoxy-Resin
 Rivet: Copper Alloy

CONTACT PLATING
 Underplate :50u"~150u" Nickel
 Contact Area :1u"~30u" Selective Gold
 Rivet :50u"~100u" Nickel

ELECTRICAL
 Operation Voltage :250 VAC Max
 Current Rating :3 Amps Max
 Contact Resistance :15 Mohms Min 500 VDA
 Dielectric Withstanding Voltage 1000 VAC/Minute
 Temperature Range :-55°C TO +105°C
 Degree of Protection :IP67(IEC 60529)

PART NO.
 249 A E XX F S S A8 N X A 3
 1 2 3 4 5 6 7 8 9 10 11 12

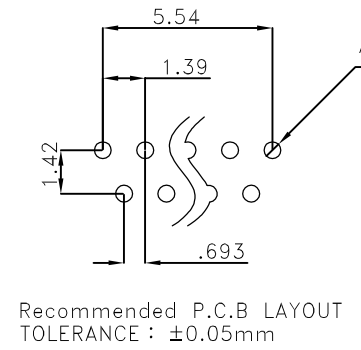
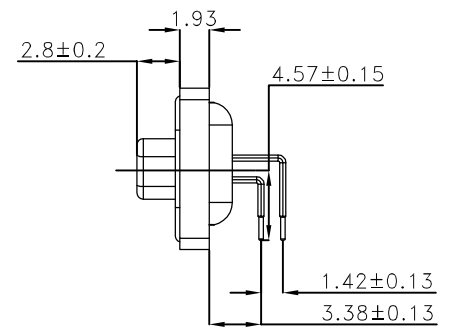
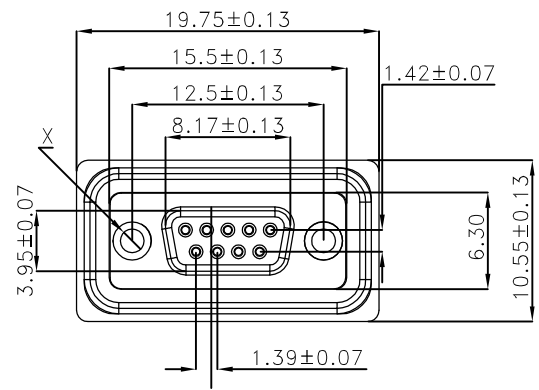

- 1.SERIES NO. 8.TYPE: A8=208A
- 2.TYPE: A=Standard 9.SHELL PLATING: N=Nickel Plated
- 3.GREEN OPTION: E=RoHS (Bright) 10.PROCESS OPTION: DIM FOR "X"
- 4.CONTACT NUMBER: 09 15 25 37 2=Fixed Hex-Rivet 4.5*4.6(4#40)
- 5.CONTACT TYPE: F=Female 11.PACKING: A=TRAY
- 6.PLATED ON THE CONTACT SIDE: S=Gold Flash 12.INSULATOR COLOR: 3=Black
- 7.PLATED ON THE SOLDERING SIDE: S=Gold Flash

PIN	A	B	C	D	W	Y	Z
9	39.50	31.00	25.00	16.34	25.20	20	11.08
15	48.00	39.30	33.32	24.66	33.50	28.30	19.39
25	61.50	53.20	47.04	38.38	47.20	42	33.24
37	77.80	69.50	63.50	54.84	63.70	58.5	49.86

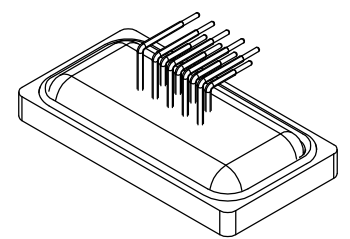

UNLESS OTHERWISE SPECIFIED TOLERANCE	
ANG.	±5°
0.	±0.50
.0	±0.30
.00	±0.20



CHANT SINCERE CO.,LTD
 TEL:886-02-86471251 FAX:886-02-86472962

SCALE: AS SHOWN	UNIT: mm
DRAWN PEARL	11/16/2016
CHECKED	/ /
APPROVED	/ /

DRAWN NAME:
 WATER-PROOF D-SUB (DIP90 ° FEMALE)
 PRODUCT NO. 249AEXXFSSA8NXA3

REV.	DESCRIPTION	DATE	SIZE	REV.	FILE NAME:
1			A4	C	C-249AEXXFSSA8NXA3