

RECOMMENDED PCB LAYOUT
TOLERANCES: ±0.05mm

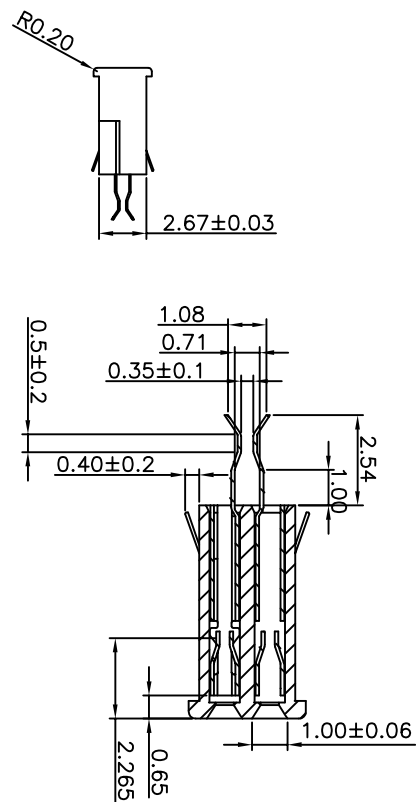

A-A(SCALE 2:1)

SPECIFICATION
MATERIAL
 Insulator: Thermal Plastic UL94V-0
 Contacts: Copper Alloy
CONTACT PLATING
 Underplate: 50u"~100u" Nickel
 Contact Area: 1u"~30u" Selective Gold
 Solder Tails Area: 100u"~200u" Tin(Lead Free)
ELECTRICAL
 Operation Voltage: 100 VAC Max.
 Current Rating: 0.5 Amps Max.
 Contact Resistance: 40 mohms Max.
 Insulation Resistance: 1000 Mohms Min. @ 500 VDC
 Dielectric Withstanding Voltage: 500 VAC / Minute
 Temperature Range: -10°C To +70°C
 Extraction Force: 0.5KG~1.0KG Based on Chant Sincere
 P/N: M2752D03-50

PART NO. 751C02 X 50 F X 0 0 X
 1 2 3 4 5 6 7 8

- | | |
|--------------------------|-------------------------------|
| 1.SERIES NO. | 5.CONTACT AREA PLATING: |
| 2.ENVIRONMENT PROTECTION | S=Gold Flash (Selective) |
| MATERIAL: | 6.FILLET WITH "0" |
| H=RoHS(Matte Tin)(無鹵) | 7.CONTACT TYPE: |
| 3.CONTACT NUMBER: | 0=Grounding Pin Standard Type |
| 50 | 8.INSULATOR COLOR: |
| 4.CONTACT TYPE: | 3=Black |
| F=Female | |

THE PRINTING CODE NO.
 CH XX XX X X X X +
 1 2 3 4 5 6 7 8
 8.MARKING FOR IDENTIFICATION
 +=Plating Lead Free

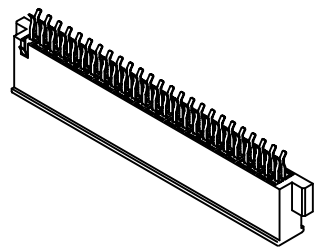

UNLESS OTHERWISE SPECIFIED TOLERANCE		 CHANT SINCERE CO., LTD TEL:886-02-86471251 FAX:886-02-86472962
ANG.	±5°	
0.	±0.5	
.0	±0.3	
.00	±0.2	
SCALE:	AS SHOWN	UNIT: mm
DRAWN	JOE	01/28/08
CHECKED	/ /	
APPROVED	/ /	
DRAWN NAME:		DRAWN NAME:
		COMPACT FLASH CONNECTOR CARD
		FEMALE CONN. STRADDLE TYPE
PRODUCT NO. 751C02X50FX00X		
FILE NAME: 751C02K50FX003(GA)		

REV.	DESCRIPTION	DATE	REV.	DESCRIPTION	DATE
1			1		
2			2		
3			3		
4			4		
5			5		
6			6		
7			7		