

RECOMMENDED P.C.B LAYOUT(TOP VIEW)
TOLERANCES: ±0.05mm

CONTACT LENGTH
DIM. FOR "X":

A	2.5mm
B	4.0mm
C	13.0mm
D	17.0mm

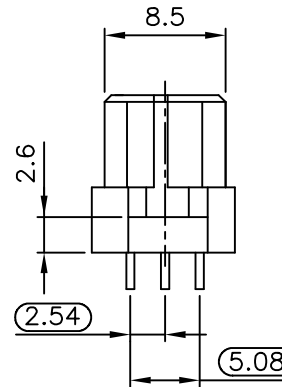

SPECIFICATION

MATERIAL

Insulator: Thermal Plastic UL94V-0

Contacts: Copper Alloy

Rivet,Boardlock: Copper Alloy

CONTACT PLATING

Underplate: 50u"~100u" Nickel

Contact Area: 1u"~30u" Selective Gold

Solder Tails Area: 100u"~200u" Tin(Lead Free)

ELECTRICAL

Operation Voltage: 250 VAC Max.

Current Rating:

TEMP(°C)	20	70	100
CURRENT	2.0A	1.6A	1.0A

Contact Resistance: 20 mohms Max.

Insulation Resistance: 1000 Mohms Min. @ 500 VDC

Dielectric Withstanding Voltage: 1000 VAC/minute

Operating Temperature: -55°C to +125°C

PART NO.

406 A X XX F X S X A X X
1 2 3 4 5 6 7 8 9 10 11

1.SERIES NO.

2.TYPE

A=Standard

3.GREEN OPTION:

J=SONY SS-00259(Reserved)

K=SONY SS-00259(Matte Tin)

(Reserved)

E=RoHS

F=RoHS(Matte Tin)

4.CONTACT NUMBER

48 96

5.CONTACT TYPE

F=Female

6.CONTACT PLATING

G=Gold Flash

S=Gold Flash (Selective)

A=5u" Gold (Selective)

B=10u" Gold (Selective)

C=15u" Gold (Selective)

D=30u" Gold (Selective)

K=1u" Gold Glash And

10u" on Contact Area

7.ANGLE TYPE

S=Straight

8.TYPE OPTION

A=C type for 96 pin

(Long body)

B=C type for 48 pin

(Short body)

9.CONTACT INSERTING OPTION

A=Three row(a+b+c)

10.CONTACT LENGTH

DIM. OF "X"

A=2.5mm

B=4.0mm

C=13.0mm

D=17.0mm

11.INSULATOR COLOR

4=Gray

5=Gray(420C)

NOTE:

PART NO.	A	B	C	D
406AX96FXSAAXX	90.00	95.0	85.0	78.74
406AX48FXSBAXX	49.36	54.4	44.4	38.1

UNLESS OTHERWISE SPECIFIED TOLERANCE	
ANG.	±5°
0.	±0.5
.0	±0.3
.00	±0.2

SCALE: AS SHOWN UNIT: mm

DRAWN PEARL 10/11/12

CHECKED / /

APPROVED / /

DATE

SIZE A4 REV. N



CHANT SINCERE CO.,LTD
TEL:886-02-86471251 FAX:886-02-86472962

DRAWN NAME:
DIN 41612(THREE ROW) FEMALE
(C TYPE)

PRODUCT NO. 406AXXXFXSXAXX

FILE NAME: 406AK96FXSXAXX

REV.	DESCRIPTION	DATE	SIZE	REV.	FILE NAME
			A4	N	406AK96FXSXAXX