

02P

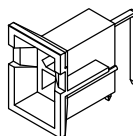

04P

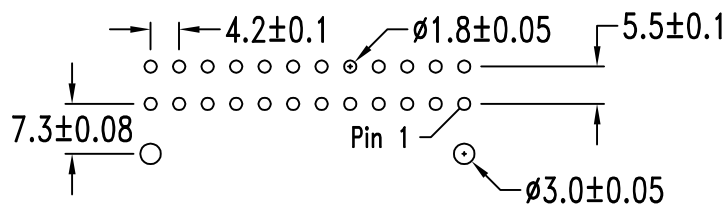
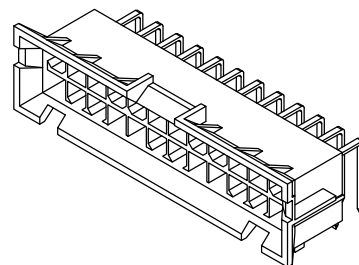
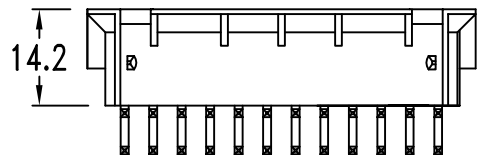
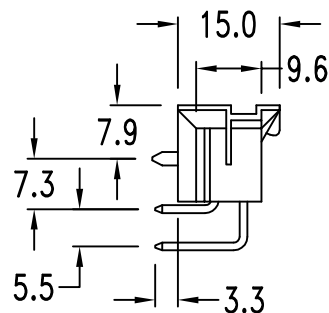
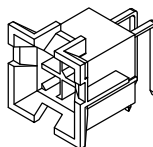

P. C. board hole dimension  
Thick.: .070"(1.78mm) Max.

Dimensional Information ( mm )

POSITION	Dim. A	Dim. B	POSITION	Dim. A	Dim. B	POSITION	Dim. A	Dim. B
2		11.0	10	16.8	27.8	18	33.6	44.6
4	4.2	15.2	12	21.0	32.0	20	37.8	48.8
6	8.4	19.4	14	25.2	36.2	22	42.0	53.0
8	12.6	23.6	16	29.4	40.4	24	46.2	57.2

Features:

- .045"(1.14mm) square pin
- Material: UL 94V-0
- Tin-plated brass pin
- Mates with 312A(D10X)Male, 312A(D105)Male housings

Specification:

- Voltage rating: 600V AC, DC ( R.M.S. )
- Current rating and wire size:

Maximum current rating ( Amperes )				
Amperes Wire	Ckt Size			
	2	4, 6	8, 10	12~24
AWG #16	9	8	7	6
AWG #18	7	6	5	4
AWG #20	6	5	4	4
AWG #22	5	4	4	4
AWG #24	4	3	3	3
AWG #26	2	1	1	1
AWG #28	1	1	1	1

- Insulation resistance: DC 500V 1000Ω Min.
- Dielectric withstanding voltage: 1500V AC/minute
- Ambient temperature range: -40°C ~ 105°C  
( including temperatute rise )

PART NO.

311 A E XX M B T D1 R 5 D 1  
1 2 3 4 5 6 7 8 9 10 11 12

- SERIES NO.
- TYPE D=DIP
- GREEN OPTION  
E=RoHS
- CONTACT NO.  
02~24
- CONTACT TYPE  
M=Male
- ROW TYPE  
B=Dual Row
- CONTACT PLATING  
T=Tin Plated
- PITCH OPTION  
D1=4.2mm
- CONTACT OPTION  
R=Right Angle
- PROCESS OPTION  
5=TYPE 3
- PACKAGE OPTION  
D=Bag
- INSULATOR COLOR  
1=White

UNLESS OTHERWISE SPECIFIED TOLERANCE	
.0	±0.40
.00	±0.25
.000	±0.08
SCALE: AS SHOWN	UNIT: mm
DRAWN PEARL	10/17/13
CHECKED	/ /
APPROVED	/ /



CHANT SINCERE CO., LTD  
TEL:886-02-86471251 FAX:886-02-86472962

DRAWN NAME:  
WAFER Pitch 4.2mm  
PRODUCT NO. 311AEXXMBTD1R5D1  
FILE NAME: 311AEXXMBTD1R5D1(W3)

REV.	DESCRIPTION	DATE	SIZE	REV.
1			A4	X1