

P. C. board hole dimensions

Dimensional Information (mm)

POSITION	Dim. A	Dim. B	POSITION	Dim. A	Dim. B	POSITION	Dim. A	Dim. B
2	2.5	7.5	6	12.5	17.5	10	22.5	27.5
3	5.0	10.0	7	15.0	20.0	11	25.0	30.0
4	7.5	12.5	8	17.5	22.5	12	27.5	32.5
5	10.0	15.0	9	20.0	25.0			

Features:

- UL 94V-0 nylon 66
- Tin-plated brass pin
- .027"(0.7mm) straight round pins
- Mates with 312A(B201) series housing
- Polarized
- Friction lock

Specification:

- Current rating: 3A Max.
- Voltage rating: 250V
- Dielectric withstanding voltage: 1000V AC/minute
- Contact resistance: 20mΩ Max.
- Ambient temperature range: -40°C ~ 105°C

PART NO.

311 A E XX M A T B2 R 1 D 1
 1 2 3 4 5 6 7 8 9 10 11 12

- | | |
|-------------------|--------------------|
| 1.SERIES NO. | 8.PITCH OPTION |
| 2.TYPE D=DIP | B2=2.5mm |
| 3.GREEN OPTION | 9.CONTACT OPTION |
| E=RoHS | R=Right Angle |
| 4.CONTACT NO. | 10.PROCESS OPTION |
| 02~12 | 1=TYPE 1 |
| 5.CONTACT TYPE | 11.PACKAGE OPTION |
| M=Male | D=Bag |
| 6.ROW TYPE | 12.INSULATOR COLOR |
| A=Single Row | 1=White |
| 7.CONTACT PLATING | |
| T=Tin Plated | |

UNLESS OTHERWISE SPECIFIED TOLERANCE	
.0	±0.40
.00	±0.25
.000	±0.08

SCALE: AS SHOWN	UNIT: mm
DRAWN PEARL	10/17/13
CHECKED	/ /
APPROVED	/ /



CHANT SINCERE CO., LTD
 TEL:886-02-86471251 FAX:886-02-86472962

DRAWN NAME:	WAFER Pitch 2.5mm
PRODUCT NO.	311AEXXMATB2R1D1
FILE NAME:	311AEXXMATB2R1D1(W3)

REV.	DESCRIPTION	DATE

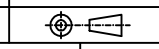

SIZE A4 REV. X1