

PORT SPACING
DIM. OF "X"

A	15.875
B	19.05
C	22.86

PROCESS OPTION
DIM. OF "Y"

A	6.90
D	7.90

PARTS DIMENSION TABLE

parts no.	DIM. a	DIM. b	inner thread	out thread
C	4.8	11.8	4#40	4#40
E	5.8	12.0	4#40	4#40
G	4.8	11.8	M3	4#40
I	5.8	12.0	M3	4#40

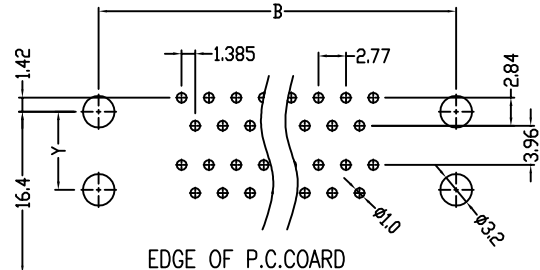
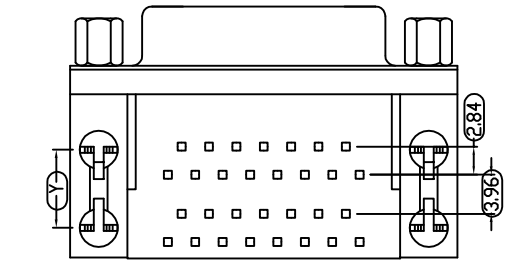

EDGE OF P.C.BOARD
RECOMMENDED P.C.B LAYOUT (TOP VIEW)
TOLERANCES:±0.05MM

POSITION	A	B	C	D
9	16.92	25.00	30.8	16.30
15	25.25	33.30	39.2	24.60
25	38.96	47.10	53.1	38.30
37	55.42	63.50	69.4	54.80

SPECIFICATION
MATERIAL
 Insulator:Thermal Plastic UL94V-0
 Contacts:Copper Alloy
 Shell:Steel
 Rivet,Boardlock:Copper Alloy
CONTACT PLATING
 Underplate:50u"~100u" Nickel
 Contact Area:1u"~30u" Selective Gold
 Solder Tails Area:100u"~200u" Tin/Lead (Brighten Tin)or
 100u"~200u" Tin/Lead Free(Brighten Tin/Matte Tin)

ELECTRICAL
 Operation Voltage:3 Amps Max
 Current Rating:3 Amps Max
 Contact Resistance:25 mohms Max
 Insulation Resistance:3000 Mohms Min @ 500 CDV
 Dielectric Withstanding Voltage: 1000 VAC / Minute
 Temperature Range: -55°C TO +105°C
 PART NO.

213 A X XX B X X X X X 3
1 2 3 4 5 6 7 8 9 10 11

- SERIES NO.
- TYPE: A=Standard
- GREEN OPTION:
E=RoHS(Bright)
- CONTACT NUMBER
09=09/09
15=15/15
25=25/25
37=37/37
- CONTACT TYPE:
B=M/F
- CONTACT AREA PLATING:
G=Gold Flash
S=Gold Flash(Selective)
- TYPE:
A=Standard(Tin Shell)
- PORT SPACING:
DIM. OF "X"
A=15.875mm(0.625')
- PROCESS OPTION:
DIM. OF "Y"
A=Dual Boardlocks
(Center Line 6.90mm)
- PARTS DIMENSION:
C=Fixed Hex-Screws(4.8*11.8)
- INSULATOR: 3=Black

UNLESS OTHERWISE SPECIFIED TOLERANCE
 ANG. ±5°
 0. ±0.5
 .0 ±0.3
 .00 ±0.2



CHANT SINCERE CO.,LTD
 TEL:886-02-86471251 FAX:886-02-86472962

SCALE: AS SHOWN UNIT: mm
 DRAWN PEARL 07/22/2015
 CHECKED / /
 APPROVED / /

DRAWN NAME:
D-SUB DUAL PORT M/F
 PRODUCT NO. 213AXXBXXXXX3
 FILE NAME: 213AKXXBXAAC3(60)

REV.	DESCRIPTION	DATE	SIZE A4	REV. B