

parts no.	DIM. a	DIM. b	inner thread
G	5.0	10.0	4#40
J	4.8	11.8	4#40
K	5.8	12.0	4#40
M	5.8	10.0	4#40
N	5.0	8.5	4#40
P	4.8	11.8	M3
Q	5.0	10.0	M3

SPECIFICATION
MATERIAL
 Insulator: Thermal Plastic UL94V-0
 Contacts: Copper Alloy
 Shell: Steel
 Rivet,Boardlock: Copper Alloy
CONTACT PLATING
 Underplate: 50u"~100u" Nickel
 Contact Area: 1u"~30u" Selective Gold
 Solder Tails Area: 100u"~200u" Tin(Lead Free)
ELECTRICAL
 Operation Voltage: 250 VAC Max.
 Current Rating: 3 Amps Max.
 Contact Resistance: 15 mohms Max.
 Insulation Resistance: 3000 Mohms Min @ 500 VDC
 Dielectric Withstanding Voltage: 1000 VAC / Minute
 Temperature Range: -55°C TO +105°C
 Torque : 3kgcm
 Part no.

202 A X XX X X X X X A X
 1 2 3 4 5 6 7 8 9 10 11

- 1.SERIES NO.
- 2.TYPE: A=Standard
- 3.GREEN OPTION:
E=RoHS(Bright)
- 4.CONTACT NUMBER:
09 15 19 23 25 37
- 5.CONTACT TYPE:
M=Male(Length:4.1±0.5mm)
- 6.CONTACT AREA PLATING:
G=Gold Flash
S=Gold Flash(Selective)
P=Tin Plated+Dimple
- 8.PROCESS OPTION:
DIM. FOR "X"
I=5.8mm Boardlock Rivet
- 9.PARTS OPTION:
G=REAR Rivet+Fixed HEX
- 10.CONTACT INSERTING OPTIN:
A=FULLY LOADED
- 11.INSULATOR COLOR:
3=BLACK

CONTACT TYPE DIM. FOR "L":

M	4.1±0.5mm
A	3.15mm
E	2.1mm
L	4.2mm

PROCESS OPTION DIM. FOR "X":

I	5.8mm
R	6.5mm
S	5.0mm
1	8.7mm
2	10.0mm
3	5.8mm
5	8.0mm
6	6.7mm
13	6.2mm

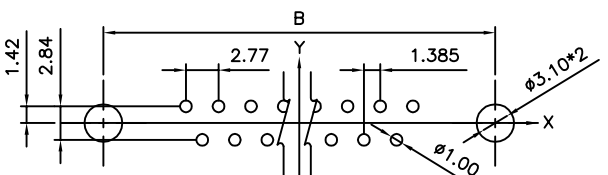
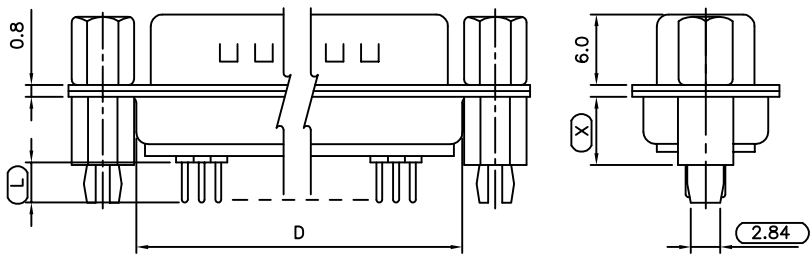

RECOMMENDED P.C.B LAYOUT (TOP VIEW)
 TOLERANCES: ±0.05mm

POSITION	A	B	C	D
9(M,A,EL)	16.92	25.00	30.8	19.2
15(M,A,EL)	25.25	33.30	39.2	27.7
19(M,A,EL)	30.60	38.86	44.8	32.8
23(M,A,EL)	35.90	44.30	50.3	38.3
25(M,A,EL)	38.96	47.10	53.1	41.1
37(M,A,EL)	55.42	63.50	69.4	57.3

UNLESS OTHERWISE SPECIFIED TOLERANCE
 ANG. ±5°
 0. ±0.5
 .0 ±0.3
 .00 ±0.2



CHANT SINCERE CO., LTD
 TEL:886-02-86471251 FAX:886-02-86472962

SCALE: AS SHOWN UNIT: mm
 DRAWN Vicky 10/20/14
 CHECKED / /
 APPROVED / /

DRAWN NAME: D-SUB PCB STRAIGHT

PRODUCT NO. 202AXXXXXXXXXXAX

REV.	DESCRIPTION	DATE	SIZE A4	REV. D	FILE NAME: 202AKXXMXXIGAX
1					
2					
3					
4					
5					
6					
7					
8					
9					
10					