

SPECIFICATION
MATERIAL
 Insulator: Thermail Plastic UL94V-0
 Contacts: Copper Alloy
 Shell: Steel
 Rivet, Boardlock: Copper Alloy
CONTACT PLATING
 Underplate: 50u"~100u" Nickel
 Contact Area: 1u"~30u" Selective Gold
 Solder Tails Area: 100u"~200u" Tin/Lead or 100u"~200u" Tin(Lead Free)
ELECTRICAL
 Operation Voltage: 250 VAC Max.
 Current Rating: 3 Amps Max.
 Contact Resistance: 15 mohms Max.
 Insulation Resistance: 3000 Mohms Min. @ 500 VDC
 Dielectric Withstanding Voltage: 1000 VAC / minute
 Temperature Range: -55°C to +105°C
 PART NO.

$\frac{202}{1} \frac{A}{2} \frac{X}{3} \frac{XX}{4} \frac{X}{5} \frac{X}{6} \frac{X}{7} \frac{X}{8} \frac{X}{9} \frac{A}{10} \frac{X}{11}$

- | | |
|---------------------------|-----------------------------|
| 1.SERIES NO. | 8.PROCESS OPTION: |
| 2.TYPE: A=Standard | DIM. FOR "X" |
| 3.GREEN OPTION: | I=5.8mm Boardlock Rivet |
| E=RoHS | |
| 4.CONTACT NUMBER: | 9.PARTS OPTION: |
| 09 15 19 23 25 37 | E=Rear Rivet |
| 5.CONTACT TYPE: | 10.CONTACT INSERTING OPTIN: |
| F=Female | A=Fully Loaded |
| S=Female(Phosphor Bronze) | 11.INSULATOR COLOR: |
| 6.CONTACT AREA PLATING: | 3=Black |
| G=Gold Flash | |
| S=Gold Flash (Selective) | |
| 7.SHELL PLATING: | |
| T=Tin Plated | |

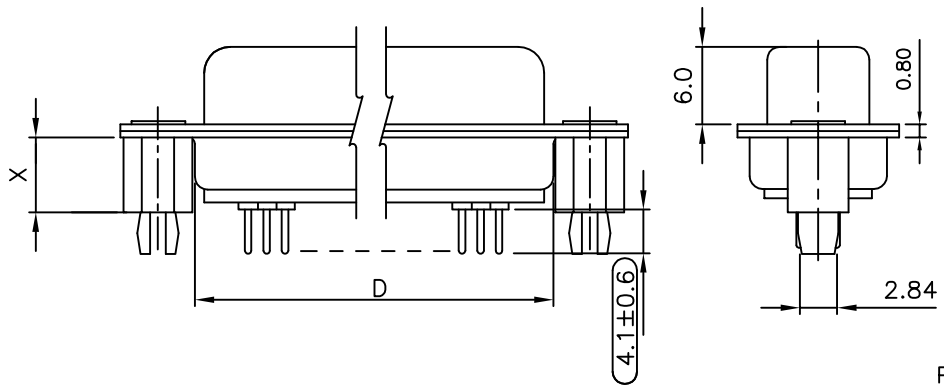

PROCESS OPTION DIM. FOR "X":

I	5.8mm
S	5.0mm
6	6.7mm

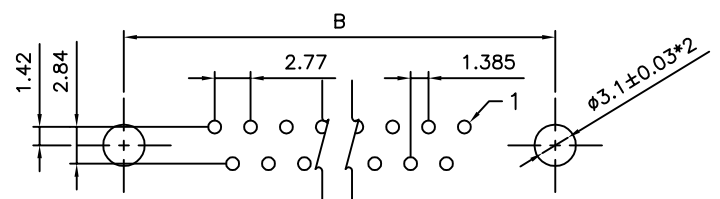

RECOMMENDED P.C.B LAYOUT (TOP VIEW)
 TOLERANCES: ±0.05mm

POSITION	A	B	C	D
9F(B,D,G,S)	16.30	25.00	30.8	19.2
15F(B,D,G,S)	24.60	33.30	39.2	27.7
19F(B,D,G,S)	30.00	38.86	44.8	32.8
23F(B,D,G,S)	35.30	44.30	50.3	38.3
25F(B,D,G,S)	38.30	47.10	53.1	41.1
37F(B,D,G,S)	54.80	63.50	69.4	57.3



UNLESS OTHERWISE SPECIFIED TOLERANCE	
ANG.	±5°
0.	±0.5
.0	±0.3
.00	±0.2



CHANT SINCERE CO., LTD
 TEL:886-02-86471251 FAX:886-02-86472962

SCALE: AS SHOWN	UNIT: mm
DRAWN RITA	12/03/2015
CHECKED	/ /
APPROVED	/ /

DRAWN NAME:	D-SUB PCB STRAIGHT
PRODUCT NO.	202AXXXXXXXXXAX
FILE NAME:	202AKXXFXXIEAX

REV.	DESCRIPTION	DATE
1		
2		
3		
4		
5		
6		
7		

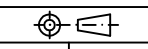

SIZE A4 REV. P