

parts no.	DIM. a	DIM. b	inner thread
F	5.0	9.5	4#40
H	4.8	11.8	4#40

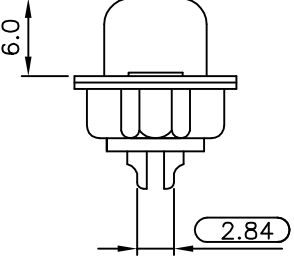
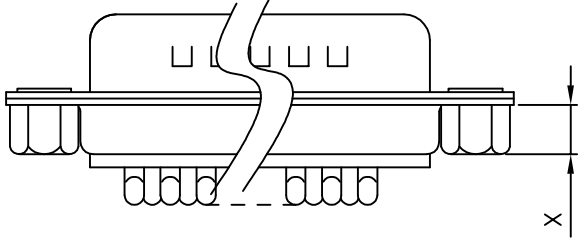

PROCESS OPTION DIM. FOR "X":

C	3.8mm
D	5.8mm
K	2.5mm

POSITION	A	B	C	D
9M	16.92	25.00	30.8	19.2
15M	25.25	33.30	39.2	27.7
19M	30.60	38.86	44.8	32.8
23M	35.90	44.30	50.3	38.3
25M	38.96	47.10	53.1	41.1
37M	55.42	63.50	69.4	57.3

SPECIFICATION
MATERIAL
 Insulator: Thermal Plastic UL94V-0
 Contacts: Copper Alloy
 Shell: Steel
 Rivet,Boardlock: Copper Alloy
CONTACT PLATING
 Underplate: 50u"~150u" Nickel
 Contact Area: 1u"~50u" Selective Gold
 Solder Tails Area: 100u"~300u" Tin(Lead Free)
ELECTRICAL
 Operation Voltage: 250 VAC Max.
 Current Rating: 3 Amps Max.
 Contact Resistance: 15 mohms Max.
 Insulation Resistance: 3000 Mohms Min. @ 500 VDC
 Dielectric Withstanding Voltage: 1000 VAC / minute
 Temperature Range: -55°C To +105°C
PART NO.

201 A X XX M X X X X A X
 1 2 3 4 5 6 7 8 9 10 11

- 1.SERIES NO.
- 2.TYPE: A=Standard
- 3.GREEN OPTION: E=RoHS(Bright)
- 4.CONTACT NUMBER: 09 15 25 37
- 5.CONTACT TYPE: M=Male
- 6.CONTACT AREA PLATING: G=Gold Flash
- 7.SHELL PLATING: P=Tin Plated+Dimple
- 8.PROCESS OPTION: DIM. FOR "X" C=3.8mm Open Hex Rivet
- 9.PARTS OPTION: E=Rear Rivet
- 10.CONTACT INSERTING OPTIN: A=Fully Loaded
- 11.INSULATOR COLOR 3=Black



UNLESS OTHERWISE SPECIFIED TOLERANCE	
ANG.	±5°
0.	±0.5
.0	±0.3
.00	±0.2

CHANT SINCERE CO., LTD
 TEL:886-02-86471251 FAX:886-02-86472962

SCALE: AS SHOWN	UNIT: mm
DRAWN RITA	12/03/2015
CHECKED	/ /
APPROVED	/ /

DRAWN NAME:	D-SUB SOLDER
PRODUCT NO.	201AXXXMXXXEAX
FILE NAME:	201AKXXMXXCEAX

REV.	DESCRIPTION	DATE	SIZE	REV.
			A4	F